

Welcome to
Saint Charles Borromeo Seminary
Move-In Information for 2020-2021

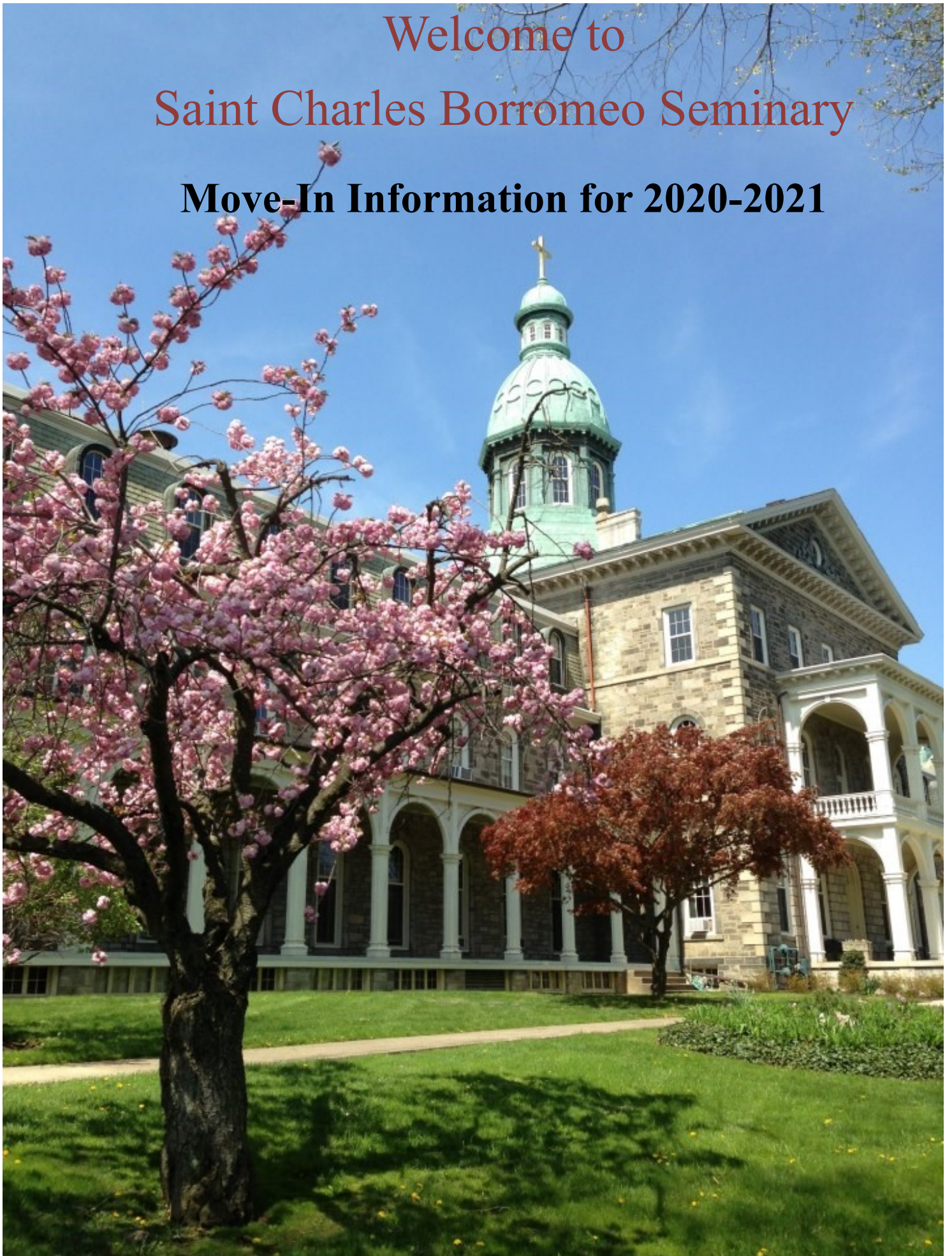

WHAT'S INSIDE

Welcome from the Deans of Men.....	4
Address, including GPS Address	5
Directions	5
Contact Information.....	6
College Residence Halls.....	7
Theology Residence Halls.....	8
Clothing for College.....	9
Clothing for Pre-Theology	10
Clothing for Theology	11
Linens/Toiletries.....	12
Luggage	12
Laundry	12
Books.....	13
Pets	13
Tuition and Financial Aid.....	14
Student Activities Fees.....	14
Spiritual Life.....	15
Recreation.....	16
Vehicles/Parking.....	17
Medical Services	17
Drug and Alcohol Policy	18
Safety /Security Services	19
Master Calendar.....	19
What to Bring (Quick List).....	20
What not to Bring (Quick List)	20
Hotels.....	21
Restaurants	21
Shopping.....	21
Campus Map, College Seminary.....	22
Campus Map, Theological Seminary	23



Welcome!

As you begin your journey of formation to the Priesthood at Saint Charles Borromeo Seminary, the faculty and administration are eager to help you transition smoothly to your new home. The following pages list housing details, practical moving tips, contact information and more. If you have questions not addressed in this information packet, please contact us.

We pray for your safe travel and look forward to your joining our Seminary community.

God Bless,

Father George J. Szparagowski
Dean of Men, College Seminary

Father Brian Kane
Dean of Men, Theological Seminary

ADDRESS

Mailing Address

Saint Charles Borromeo Seminary
100 E. Wynnewood Road
Wynnewood, PA 19096-3001

GPS Address

100 E. Wynnewood Road
Merion Station, PA 19096



DIRECTIONS

Saint Charles Borromeo Seminary is at the intersection of Wynnewood Road and City Line Avenue in Wynnewood, PA. The entrance to the Seminary is located on Wynnewood Road. When you arrive on campus, the Safety Officer at the gatehouse will direct you to suitable parking.

From Philadelphia International Airport:

Take ramp on the left to Interstate 95 North, take exit 22 on the left toward US-30W/Central Philadelphia, merge onto the Vine Expressway. Continue on the Vine Expressway and keep left at the fork. Follow signs for Interstate 76/US-30 W/Valley Forge and merge onto Interstate 76 W. Take Exit 339 on the left and merge onto U.S. 1 S/City Avenue. Go approximately 3 miles and turn right onto Wynnewood Road, then left onto the Seminary campus.

From the North:

Follow PA Turnpike to Rte.476 (Old Exit 25A/New Exit 20). Follow 476 South to Rte. 76 East, toward Philadelphia. Follow Rte. 76 East to Exit 339 (Rte. 1, City Avenue). Follow approximately 3 miles to Wynnewood Road. Make a right, then left onto the Seminary campus.

From the South:

Interstate 95 North to 476 North. Follow 476 North to Exit 5 (Rte. 1). Follow Rt. 1 North to Wynnewood Road (approximately 8 miles). Make a left onto Wynnewood Road, left onto the Seminary campus.

From the West:

PA Turnpike to Old Exit 24/New Exit 326 (Valley Forge). Follow Rte. 76 East, toward Philadelphia, to Exit 339 (Rte. 1, City Avenue). Follow approximately 3 miles to Wynnewood Road. Make a right, then left onto the Seminary campus.

CONTACT INFORMATION

Campus Information Center

Sheila Longworth (610) 785-6527 slongworth@scs.edu

Campus Security and Safety Services

Mr. Sam Hoffsommer, Director (610) 785-6263 shoffsommer@scs.edu

Office of the Vice President for Academic Affairs

Reverend Robert A. Pesarchick, Vice President for Academic Affairs

Michelle Lesniak, Secretary (610) 785-6575 mlesniak@scs.edu

Office of the Dean of Men, College Seminary

Reverend George J. Szparagowski, Dean of Men, College Seminary

Jean Ann Discavage, Secretary (610) 785-6205 jdiscavage@scs.edu

Office of the Dean of Men, Theological Seminary

Reverend Brian Kane, Dean of Men, Theological Seminary

Maryclare Ramuno, Secretary (610) 785-6228 deanofmentd@scs.edu

Office of Finance and Operations

Barbara Coady, Director of Financial Services (610) 785-6201 bcoady@scs.edu

Nora Downey, Financial Aid Coordinator (610) 785-6582 ndowney@scs.edu

Office of Information Technology

IT Help Desk (610) 785-6528 servicehelp@scs.edu

Ryan Memorial Library

Anthony Cardinal Bevilacqua Research Center

Circulation Desk (610) 785-6274 rmlibrary@scs.edu

<http://library.scs.edu/>

COLLEGE RESIDENCE HALLS



- ◆ College seminarians reside in either Saint John Hall or Saint Stephen Hall.
- ◆ The room size is 14' x 13'.
- ◆ Each room is carpeted and air-conditioned.
- ◆ These residence halls are equipped with private bathrooms.

- ◆ Each room has a bed with a standard twin size mattress, bureau, desk, desk chair, bookcase, desk lamp, club chair and a floor lamp. Be mindful of limited desk space in your room.
- ◆ Please be careful of the walls when moving your things into your rooms. 3M Command products may be used to hang items on the walls. Use of nails, tacks, tape or adhesive on the walls is not permitted. Nothing is to be affixed to your door.
- ◆ Remember to bring an alarm clock.
- ◆ Seminarians may bring their own audio equipment.
- ◆ Computer equipment may be kept in each seminarian's room.
- ◆ Wi-Fi is available in the second floor student lounge and the library. Internet access is also available through use of Seminary computers in the library.
- ◆ Televisions, DVD players, refrigerators, microwaves and toasters are located in the seminarians' Common Room and are not allowed in the residence halls.
- ◆ Our local fire department requires that all students keep a working flashlight in their rooms in the event of any emergency. Smoke detectors are located in each room. These may not be tampered with at any time.
- ◆ Smoking is prohibited indoors.

THEOLOGY RESIDENCE HALLS



- ◆ Pre-Theology II and most Theology seminarians reside in Saint John Vianney Hall (Vianney Hall).
- ◆ The room size is 9'x16'.
- ◆ Each room has a linoleum floor and is air-conditioned.
- ◆ This residence hall is equipped with semi-private bathrooms; a sink is located in each room.

- ◆ Each room has a bed with a standard twin size mattress, bureau, desk, desk chair, bookcase, desk lamp, club chair and a floor lamp. Be mindful of limited desk space in your room. Bed linens are not supplied.
- ◆ Computer equipment may be kept in each seminarian's room.
- ◆ Wi-Fi is available throughout Vianney Hall, including classrooms, student rooms, and the Common Room, and in the library. Internet access is also available through use of Seminary computers in the library.
- ◆ Please be careful of the walls when moving your things into your rooms. 3M Command products may be used to hang items on the walls. Use of nails, tacks, tape or adhesive on the walls is not permitted. Nothing is to be affixed to your door.
- ◆ Remember to bring an alarm clock.
- ◆ Seminarians may bring their own audio equipment.
- ◆ Televisions, DVD players, refrigerators, microwaves and toasters are located in the seminarians' Common Room and are not allowed in the residence halls.
- ◆ Our local fire department requires that all students keep a working flashlight in their rooms in the event of any emergency. Smoke detectors are located in each room. These may not be tampered with at any time.
- ◆ Smoking is prohibited indoors, smoking is permitted in the smoking area between Vianney and St. Edmund's hall. Seminarians are not permitted to smoke while walking on campus.

Pre-Theology I seminarians and some Theology I Seminarians will live in St. Edmund's Hall. The room dimensions and supplied furnishings are similar as above with the exception of air conditioning. A fan is supplied in each room and there is a common bathroom in the center of the hall with a sink in each room.

CLOTHING FOR COLLEGE

- ◆ New seminarians wear a plain black suit with white shirt, black tie, black socks and black dress shoes for Opening Day. The same attire is worn by new seminarians on formal occasions. Based on each seminarian's preference, white shirts may be short or long sleeved; oxford shirts are also permitted.
- ◆ The College Seminary Cassock Day is September 29, 2018 the day on which seminarians in the College Seminary are able to wear clerical attire (cassock, surplice). After Cassock Day, seminarians are required to wear a cassock, surplice, black dress slacks, black dress shoes and black socks for daily Mass, Solemn Morning Prayer and Evening Prayer on Sundays, Solemn Benediction, all chapel exercises during Forty Hours and when serving in liturgical roles. (At meals immediately following Mass or Solemn Evening Prayer seminarians may remain in cassock.)
- ◆ The cassock is to be a simple Roman cassock. This is a cassock with buttons down the front but without buttons on the sleeves. A sash (fascia), except one that is a part of a religious community habit, is not permitted as part of the Seminary cassock.
- ◆ The house surplice is a square yoke, white surplice without lace, ribbons, or any other liturgical decorations and is mid-thigh in length.
- ◆ For all academic classes, Evening Prayer (except on Sundays), Wednesday Morning Prayer, retreat days, days of recollection, Formation Conferences, House meetings and meetings with one's Formation Advisor, seminarians wear "Seminarian Casual", which consists of black dress slacks, black dress shoes, black socks and a collared shirt (long-sleeve or short sleeve). Sweaters are permitted, however, hoodies and sweatshirts may not be worn for "Seminarian Casual".
- ◆ Jeans, shorts, T-shirts, athletic wear, shirts with messages or advertisements, athletic shoes, and other casual clothing may be worn during exercise, recreation, free time, and lunch and dinner on Saturdays. Caps or hats should not be worn in indoor public areas (excluding the common rooms and dormitories). Each seminarian should bring an adequate supply of personal clothing so that he will have clean clothing on hand each day.
- ◆ It is advisable to look into ordering or purchasing your cassock and surplice by the start of the academic year. Non-fitted cassocks may be purchased through various religious goods stores. For your convenience, a representative from a local area Clergy Apparel vendor will be on-site sometime during the opening days of the Fall semester. Seminarians are welcome to purchase their cassock and surplice at that time.
- ◆ *College seminarians living in the Theological Seminary wear "Seminarian Casual" for all classes in the College.*
- ◆ *College seminarians living in the Theological Seminary follow the dress code guidelines for Pre-Theology I for all chapel functions (refer to page 10 of this booklet for details).*
- ◆ *College seminarians living in the Theological Seminary are advised to purchase clerical shirts at the time you purchase your cassock and surplice, as you will wear these at chapel functions after Cassock Day.*

CLOTHING FOR PRE-THEOLOGY

- ♦ New seminarians wear a plain black suit with white shirt and black tie for Opening Day. (Move-in day is casual– see orientation schedule) The same attire is worn by new seminarians on Sundays and formal occasions. Based on each seminarian’s preference, white shirts may be short or long sleeved; oxford shirts are also permitted.
- ♦ All men in Pre-Theology I & II wear “Seminarian Casual” for all classes, meals and events. “Seminarian Casual” consists of black dress slacks, black dress shoes, black socks and a collared shirt (long-sleeve or short sleeve). Sweaters are permitted, however, hoodies and sweatshirts may not be worn for “Seminarian Casual”).
- ♦ After they receive their cassocks in September the new men in Pre-Theology I begin wearing a cassock and a house surplice for Mass, for Solemn Evening Prayer, and for Solemn Benediction.
- ♦ **New seminarians in Pre-Theology should bring a cassock and surplice with them or plan to purchase these items within the first week. Vendors will be on campus during orientation.**
- ♦ The cassock is to be a simple Roman cassock. This is a cassock with buttons down the front but without buttons on the sleeves. A sash (fascia), except one that is a part of a religious community habit, is not permitted as part of the Seminary cassock.
- ♦ The house surplice is a square yoke, white surplice without lace, ribbons, or any other liturgical decorations and is mid-thigh in length.
- ♦ Non-fitted cassocks may be purchased through various religious goods stores. For your convenience, a representative from a local area Clergy Apparel vendor will be on-site sometime during the opening days of the Fall semester. Seminarians are welcome to purchase their cassock and surplice at that time. Fitted cassocks are also available from a local clerical tailor.
- ♦ Each seminarian should bring an adequate supply of personal clothing so that he will have clean clothing on hand each day.



CLOTHING FOR THEOLOGY

- ♦ New seminarians who have been admitted to Candidacy entering Theology wear a clerical shirt with collar, black pants, black socks and black shoes on Opening Day, and to all classes and chapel functions. (Move-in day attire is casual) Those who have not been admitted to Candidacy wear “Sem Casual” to all classes and meals until admitted to Candidacy.
- ♦ The clerical shirt is a black shirt that is worn with a clerical collar.
- ♦ A cassock and a house surplice are required for Mass, Solemn Evening Prayer and Solemn Benediction.
- ♦ The cassock is to be a simple Roman cassock. This is a cassock with buttons down the front but without buttons on the sleeves. A sash (fascia), except one that is a part of a religious community habit, is not permitted as part of the Seminary cassock.
- ♦ The house surplice is a square yoke, white surplice without lace, ribbons, or any other liturgical decorations and is mid-thigh in length.
- ♦ A plain black suit with white shirt, black tie, black socks and black dress shoes are worn on formal occasions outside of chapel functions for seminarians who have not yet received Candidacy. Based on each seminarian’s preference, white shirts may be short or long sleeved; oxford shirts are also permitted.
- ♦ Each seminarian should bring an adequate supply of personal clothing so that he will have clean clothing on hand each day.



LINENS/TOILETRIES



- ◆ Pillows, sheets, pillowcases, blankets and comforters for a single bed (standard twin) are to be supplied by each seminarian.
- ◆ Face towels, bath towels, and washcloths are to be supplied by each seminarian.
- ◆ Toiletries (soap, toothbrush, toothpaste, shaving cream, razor, deodorant, etc.) are to be supplied by each seminarian.

LUGGAGE

- ◆ For the transportation of clothing and other materials, ordinary luggage or strong cardboard boxes are advisable.
- ◆ Limited storage space luggage and packing cartons will be available for the duration of the school year.
- ◆ Carts are available to assist with moving into residence halls.



LAUNDRY

- ◆ Each seminarian is responsible for his own laundry.
- ◆ Washers and dryers (laundry card operated) are available.
- ◆ Detergent, bleach, fabric softener is supplied
- ◆ A laundry bag or basket is a necessity.

BOOKS

- ◆ Course book lists for all classes will be posted to Populi. Books are typically purchased on-line at the vendor of your choice.
- ◆ Course books may be shipped directly to the Seminary prior to Opening Day. All books should be sent to the seminarian's attention using the mailing address provided in this booklet. It is not unusual to wait to purchase books until the first class has been held.

PETS

- ◆ Pets are not permitted on campus at any time.



TUITION AND FINANCIAL AID

- ♦ Financial aid and tuition information is available at www.scs.edu.
- ♦ Financial Aid questions should be directed to Nora Downey or Barbara Coady in the Finance Office. Please refer to page 5 for contact information.
- ♦ Seminarians should establish or continue a savings and/or checking account. A seminarian-sponsored house bank is available primarily for check cashing purposes. Checks are cashed on a weekly basis. The Seminary is located near several full service banks.



STUDENT ACTIVITIES FEE

- ♦ To assist with the cost of campus activities, each seminarian pays a fee of \$70.00 per year. The fee will be collected by the Student Council Treasurer during Registration on Opening Day. The money collected helps to pay for various student activities sponsored by Student Council throughout the year.



SPIRITUAL LIFE

- ♦ Daily community prayer is a fundamental part of the seminarian's spiritual formation. All seminarians are required to purchase the Liturgy of the Hours (4-volume set). These may be obtained from any Catholic religious goods store. During the first three months of the academic year, only Volume 4 is needed. The other volumes may be purchased during the course of the school year. It is expected that you bring the Liturgy of the Hours - Volume 4 with you when you arrive at the Seminary. Seminarians are not permitted to use electronic versions of the Liturgy of the Hours for common prayer in the Chapel.



RECREATION

- ♦ The following sports facilities are available on campus: indoor and outdoor basketball and volleyball courts, football, baseball and softball fields, and tennis courts. A weight room and an aerobic exercise area are located on campus. The athletic facilities at Saint Joseph's University are also available for seminarian use, e.g. pools.
- ♦ Baseball gloves, tennis racquets, etc., are personally owned. The Seminary sports program supplies baseballs, bats, footballs, tennis nets, volleyballs, basketballs, etc.
- ♦ Seminarians are encouraged to bring their musical instruments with them to the Seminary. However, amplified musical instruments and drums may not be used in your room.
- ♦ Bring appropriate casual clothing for your free time.



VEHICLES/PARKING

- ♦ Seminarians may maintain a motor vehicle in designated parking areas.
- ♦ All vehicles must be registered (during Orientation) with the Department of Security and Safety Services. Auto insurance information will be reviewed by that office. Parking permits will be issued to each registered vehicle.
- ♦ Vehicles should not be left at the Seminary during vacation periods without the express permission of the Dean of Men.

MEDICAL SERVICES

- ♦ The services of a part-time nurse are available to seminarians.
- ♦ New seminarians who suffer from allergies or other continuing medical problems are asked to bring records from a family physician so that treatment can be continued during the academic year.
- ♦ Each new seminarian must possess, at the Seminary, complete information concerning membership in a program of medical coverage (e.g. Blue Cross, Blue Shield, etc.) so that in the case of accident or emergency this information will be available to the seminarian and Seminary administrators.
- ♦ A seminarian healthcare plan is available for purchase by all seminarians. New members are welcome at any time.



DRUG AND ALCOHOL POLICY

All seminarians are to observe the civil law, which forbids any use, possession or distribution of illegal drugs or controlled substances.

- ♦ Violations of local ordinances or of state or federal laws regarding controlled dangerous substances by members of the Seminary community may entail Seminary disciplinary actions regardless of where such violations occur, if they are of a serious nature (c.f. Annual Security Report).
- ♦ The manufacture, sale or distribution of illegal drugs, any involvement in illegal drug use or traffic with minors and possession or use of the more dangerous or highly addictive drugs are all considered serious offenses and will be handled accordingly (c.f. Annual Security Report).
- ♦ Any seminarian who fails to abide by the Seminary rules on illegal drugs is liable to dismissal.

All Seminarians are to observe the virtue of temperance as it relates to the consumption of alcohol.

- ♦ The legal drinking age in the state of Pennsylvania is 21 and is to be followed without fail.
- ♦ It is recommended that seminarians of a legal drinking age should not imbibe more than two alcoholic beverages within a 24 hour period.
- ♦ Seminarians are forbidden to have alcoholic beverages in their possession (e.g., in one's car, room, etc.) on the Seminary campus.
- ♦ As a point of clarification, any incidents involving the abuse of alcohol whether on campus or off campus, such as driving under the influence of alcohol or any public behavior that would be unbecoming of a seminarian in which the use of alcohol is a precipitating factor, are serious infractions of this rule.
- ♦ Seminarians of a legal drinking age are absolutely forbidden to buy or provide alcohol to anyone who is not of the legal drinking age.
- ♦ Any seminarian who fails to abide by the Seminary rules on alcohol and its consumption is liable to dismissal.
- ♦ In the Theological Seminary, on certain occasions (a house party, class dinner/barbeque, diocesan night etc.), with the expressed permission of the Dean of Men, alcoholic beverages (wine and beer) may be purchased by seminarians and consumed on the campus. These beverages are restricted to the common areas of the basement level of Vianney Hall. At no time are alcoholic beverages permitted in seminarian rooms in the residence halls. At the conclusion of each event, any remaining beverages are to be stored in the closet of the Student Common Room in Vianney Hall.

A concern for the good of the Church and fraternal charity call for a seminarian to bring any serious infractions against temperance or possession of alcohol and/or drugs on campus to the attention of the Dean of Men.

SECURITY/SAFETY SERVICES

- ◆ Two full-time campus safety officers are on campus at all times.
- ◆ The Jeanne Clery Disclosure of Campus Security Policy and Campus Crime Statistics Act (20 USC § 1092 (f)) is the federal law that requires colleges and universities to report statistics for seven major crime categories for incidents that occur on campus
- ◆ The United States Department of Education website maintains these crime statistics for the past three years. To view these statistics for the Seminary, visit the United States Department of Education website by clicking on the hyperlink or by copying and pasting the hyperlink, <http://ope.ed.gov/security/>

MASTER CALENDAR

- ◆ The Master Calendar is available for viewing on the Saint Charles Borromeo Seminary website, www.scs.edu. The link is located on the side bar and is labeled “Calendar” . The required password is included in the accompanying letter.
- ◆ Saturday is typically the free day for seminarians following Mass in the morning until the curfew Saturday night.
- ◆ Rector’s Weekends, Holidays, Christmas and Easter breaks are shown on the Seminary Master Calendar.



WHAT TO BRING

Black suit	Sheets
Black dress pants	Pillowcases
White dress shirts	Blankets
Black shoes	Comforter
Black socks	Towels
Black belt	Laundry bag or basket
Black neckties	Alarm clock
Black topcoat and/or raincoat	Flashlight
Black sweater, cardigan or pullover	Batteries
Black umbrella	Fan (College seminarians)
Robe	New American Bible (study edition)
Shower shoes	Liturgy of the Hours (four volume)
Shoeshine kit	Surge protector

WHAT NOT TO BRING

Air Conditioner	Nails, screws, hooks, thumbtacks, etc. for walls (3M Command products are acceptable)
Alcohol	Duct tape or double sided sticky tape
Illegal Drugs	Power Tools
Candle Warmer	Pets
Candles	Electric air fresheners (Glad Plug-In, potpourri pot, etc.)
Large amounts of cash (there are a number of banks and ATMs close to campus)	Refrigerator, microwave, small electric kitchen appliances (only coffeemakers with automatic shut-off are permitted in seminarian rooms)
Decorations made from alcohol containers	Gas or charcoal grills
Large Pieces of Exercise Equipment (treadmill, weight bench, etc.)	Space heater
Fake ID	Sun lamp
Firearms/weapons/explosives	Television or large computer monitors
Fireworks	Valuables and items of sentimental value
Flammable liquids	Wireless Router
Halogen bulb lamp	
Incense	
Landline Phone	
Live Christmas trees	

HOTELS

Crowne Plaza Philadelphia West

4010 City Avenue
Philadelphia, PA 19131
(215) 477-0200

Use corporate ID# 100273835 for “St. Charles Seminary” discounted rate

Hilton Philadelphia—City Avenue

4200 City Ave
Philadelphia, PA 19131
(215) 879-4000

RESTAURANTS

Hymie’s Delicatessen in Merion

342 Montgomery Avenue
Merion, PA 19066
(610) 668-3354
www.hymies.com

Overbrook Pizza

2099 N 63rd Street
Philadelphia, PA 19151
(215) 473-3303

Panera Bakery-Café

278 East Lancaster Avenue
Wynnewood, PA 19096
(610) 896-0564

Sabrina’s Café

Wynnewood Shopping Center
50 East Wynnewood Road
Wynnewood, PA 19096
(484) 412-8790

Wawa

949 Montgomery Avenue
Penn Valley, PA 19072
(610) 660-5920

SHOPPING

Wynnewood Shopping Center (includes Bed Bath and Beyond, Giant, Wynnewood Dry Cleaners)

50 E. Wynnewood Road
Wynnewood, PA 19096

Turn left out of the Seminary. Go approximately 1.4 miles down Wynnewood Road. Wynnewood Shopping Center is on the left.

LEGEND

- | | |
|---|--|
| 1. Bell Tower | 7. College Building, Center - Eakins Room |
| 2. Chapel of St. Martin of Tours | 8. College Building, Center - College Auditorium |
| 3. Oratory | 9. Fitness Center |
| 4. FOCUS | 10. College Building, West - Faculty Wing |
| 5. College Building East - Main Dining Room/Refectory | 11. Underground Tunnel to Theology Division |
| 6. College Building, Main Building or "Center of the House" | |

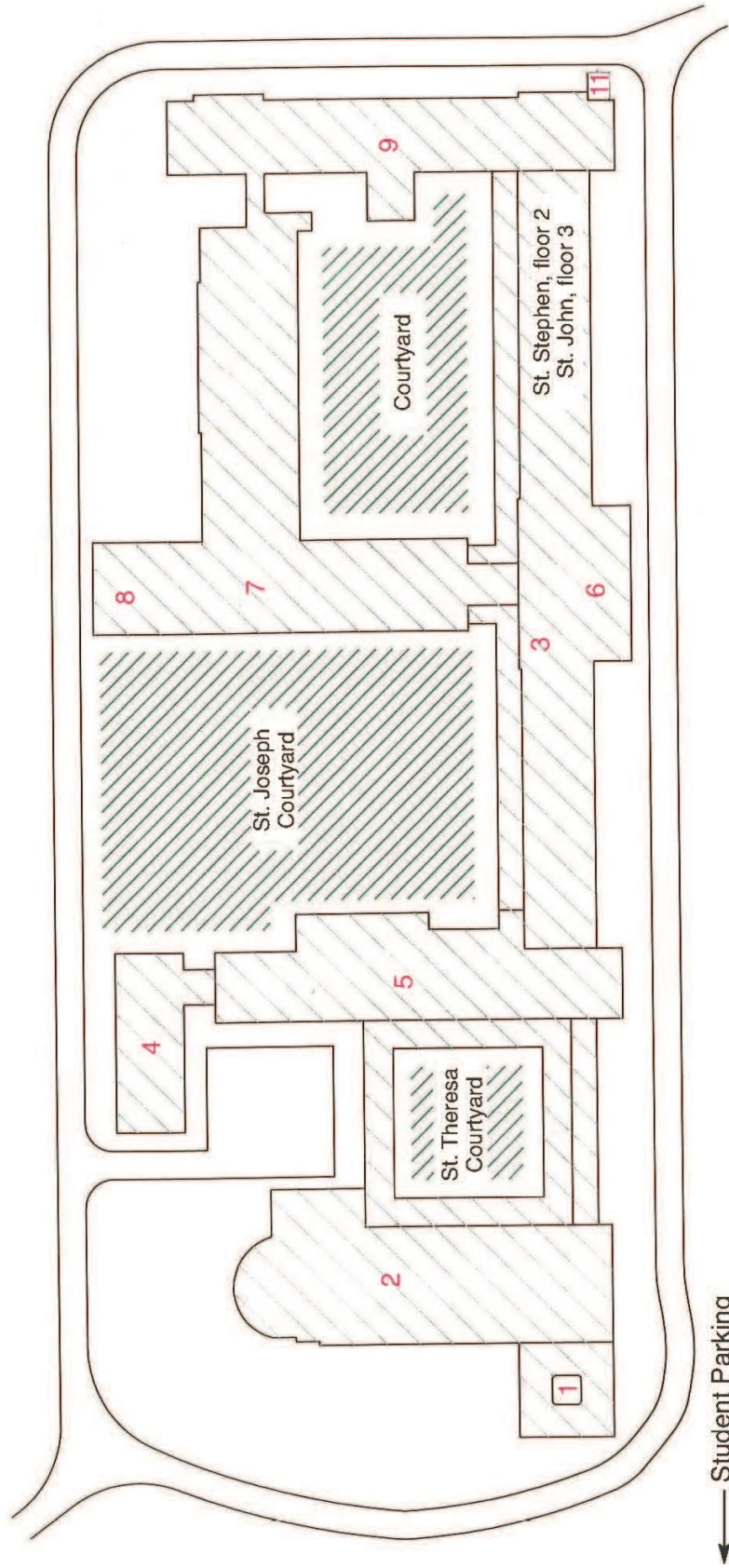

Saint Charles Borromeo Seminary

**College Division
(Lower Campus)**

← Student Parking

LEGEND

- 11. Underground Tunnel to College Division
- 12. Ryan Memorial Library
- 13. St. John Vianney Hall
- 14. Theology Building
- 15. Immaculate Conception Chapel
- 16. St. John Neumann Hall
- 17. Boiler House
- 18. St. Edmond Hall
- 19. Garage
- 20. White House

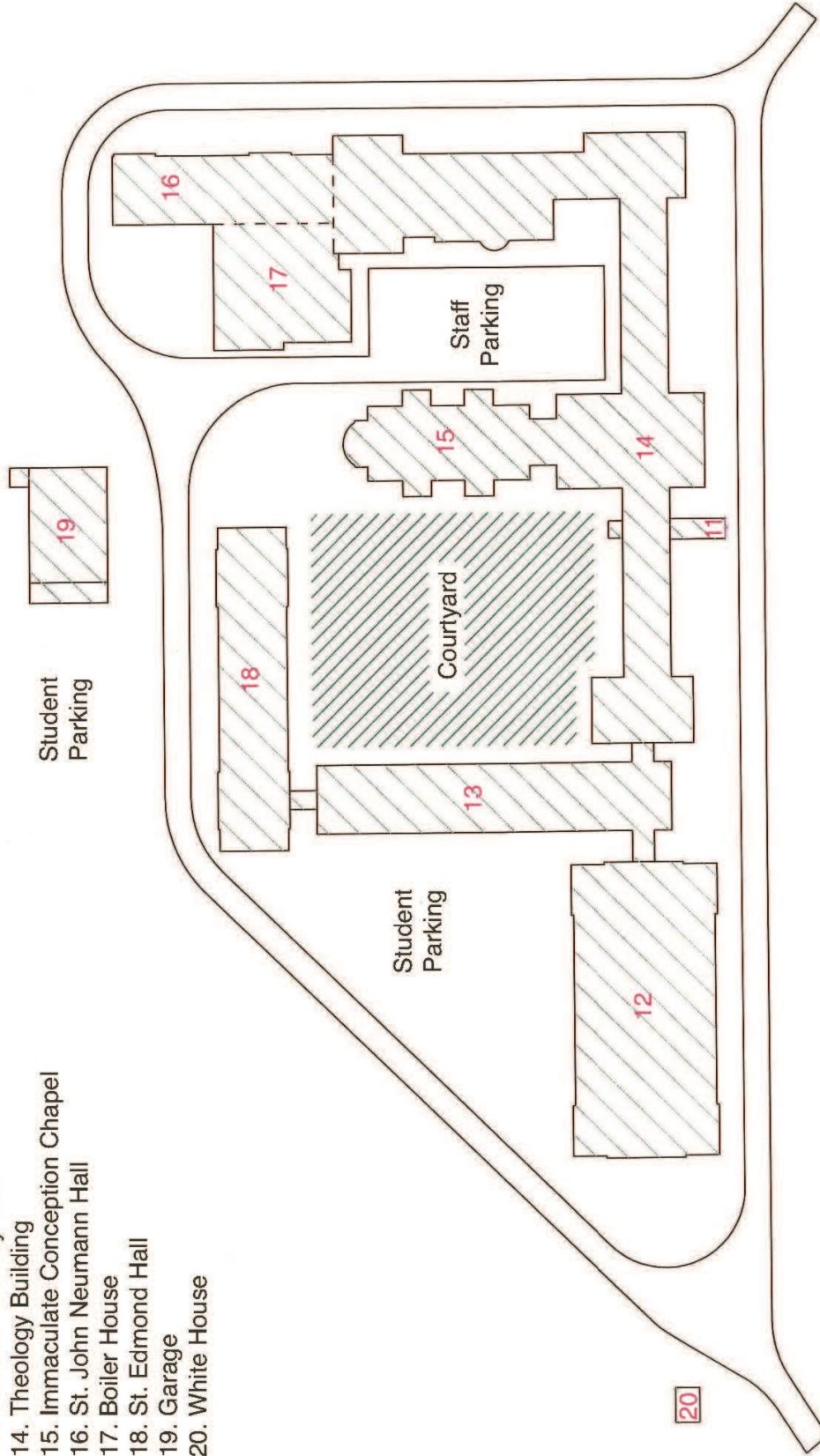

Saint Charles Borromeo Seminary Theology Division (Upper Campus)



Saint Charles Borromeo Seminary is honored to be entrusted with the priestly formation of men from the following (Arch)Dioceses and Religious Orders:

Archdiocese of Colombo, Sri Lanka
 Archdiocese of Philadelphia
 Congregation of the Mission,
 The Vincentians
 Diocese of Allentown
 Diocese of Arlington
 Diocese of Greensburg
 Diocese of Harrisburg
 Diocese of Lincoln
 Diocese of Steubenville

Diocese of Mymensingh, Bangladesh
 Diocese of Raleigh
 Diocese of Trenton
 Sodalitium Christianae Vitae (Sodalites)
 Order of Canons Regular of Prémontré—
 Norbertine Fathers
 Personal Ordinariate of the Chair of St. Peter
 Society of the Catholic Apostolate
 (Pallottines)
 The Oratory of St. Philp Neri (Oratorians)



Saint Charles Borromeo Seminary
 100 East Wynnewood Road
 Wynnewood, PA 19096-3001
www.scs.edu